

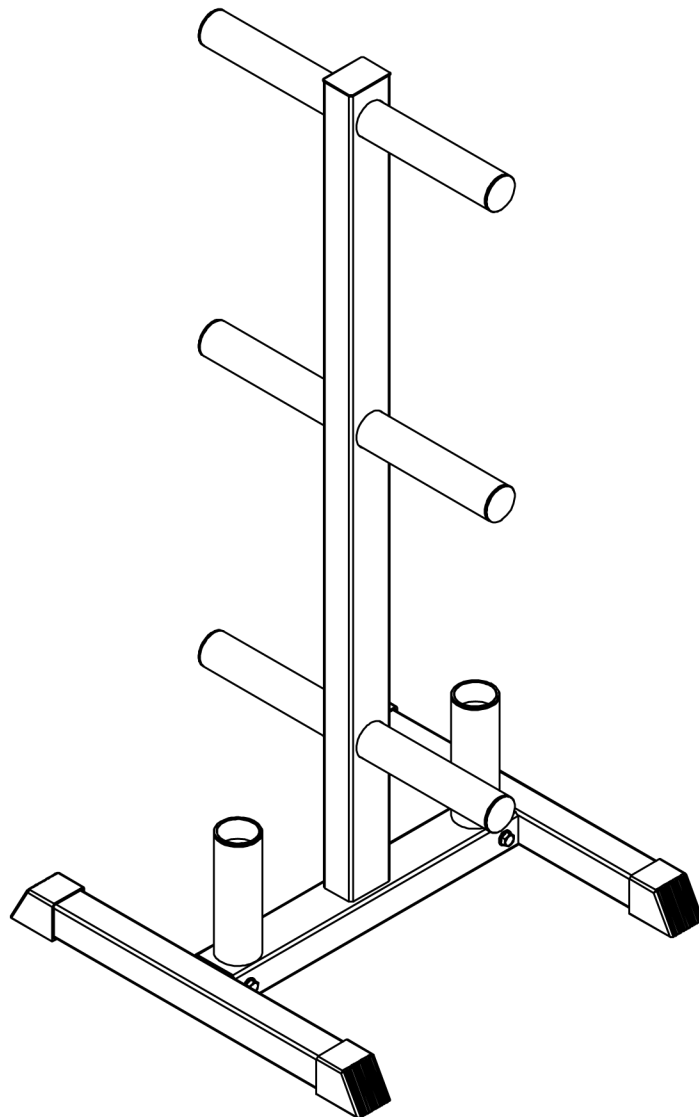

**OLYMPIC BUMPER
PLATE AND BAR HOLDER
B07DQ9D9V4/D1BPR850**

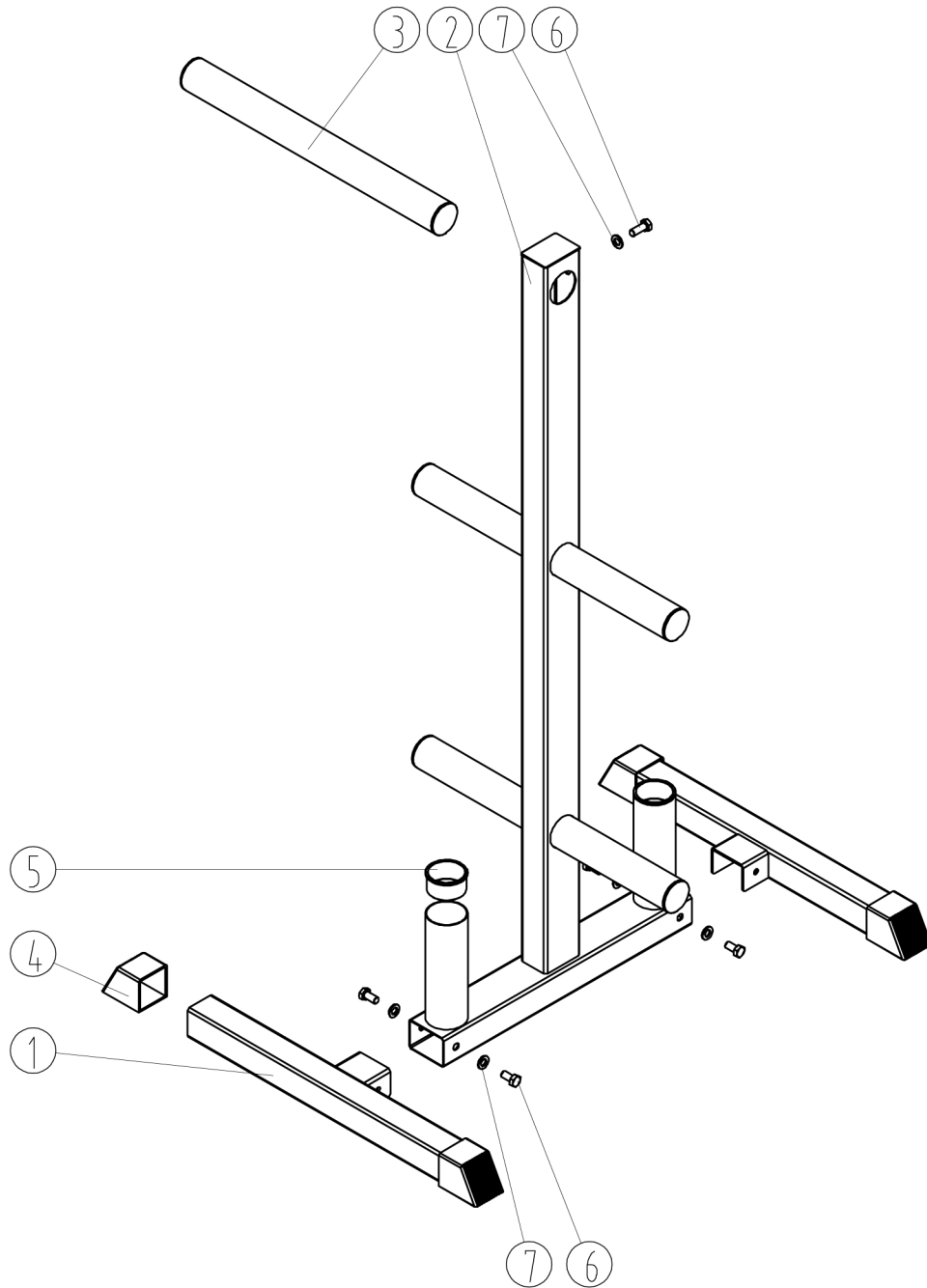



NUMBER	DESCRIPTION	QUANTITY	NUMBER	DESCRIPTION	QUANTITY
1	Base foot	2	5	Plastic bushing	2
2	Main frame	1	6	Hex Bolt M10*20	7
3	Bell tube	3	7	WASHER 10	7
4	Set foot	4			

1. Insert Set Foot (4) into Base foot (1) on both sides.
2. Attach both sides of Base Foot(1) into Main Frame (2) using Hex Bolt M10*20 (6) and Washer10 (7).
3. Insert Bell tube (3) into the Main Frame (2) and align the hole in Bell Tube (3) with the of the Main Frame (2). Attach uniting Hex M10*20 Bolts (6) with washer (7).
4. Tighten down all parts.